

\$1,495,000 - Range Road 210, Rural Northern Sunrise County

MLS® #A2243827

\$1,495,000

3 Bedroom, 2.00 Bathroom, 1,506 sqft
Agri-Business on 0.00 Acres

NONE, Rural Northern Sunrise County,
Alberta

Jet Set Retreat Located in North West Alberta Canada. This 309-Acre Estate with 3 separately Deeded parcels along The Mighty Peace River. Along with the Privacy You Would expect in a Higher end Estate. This 1500 Sq. Ft. Home offers 3 bedrooms, one and a half baths, open concept kitchen, vaulted ceilings through out the dinning and living rooms. The feature wall includes a wood burning fire place incased in stone, finishes this country cabin feel inside this home. Every thing is included from the teaspoons in the drawer to the leather couch and even the set of horns over the mantel. Outside this rustic home wrapped in cedar is a wrap around deck, views of the mighty peace valley and the wooded hills. Ideal for year round living or weekend retreats or just that special place to meet and make life long memories and friends. The three deeded parcels of land that are included with this dream property are ideal for raising cattle, as there is some fencing and cross fencing as well a grazing lease was inplace before and maybe available again if you qualify, which would add an additional 5 or more parcels of land with restrictions. The area offers some of the best hunting, fishing and recreation in Northern Alberta. The fact that this is a river flat the soil has produced quality grain, potatoes, carrots, beets, lettuce etcetera. The reality is if you have been

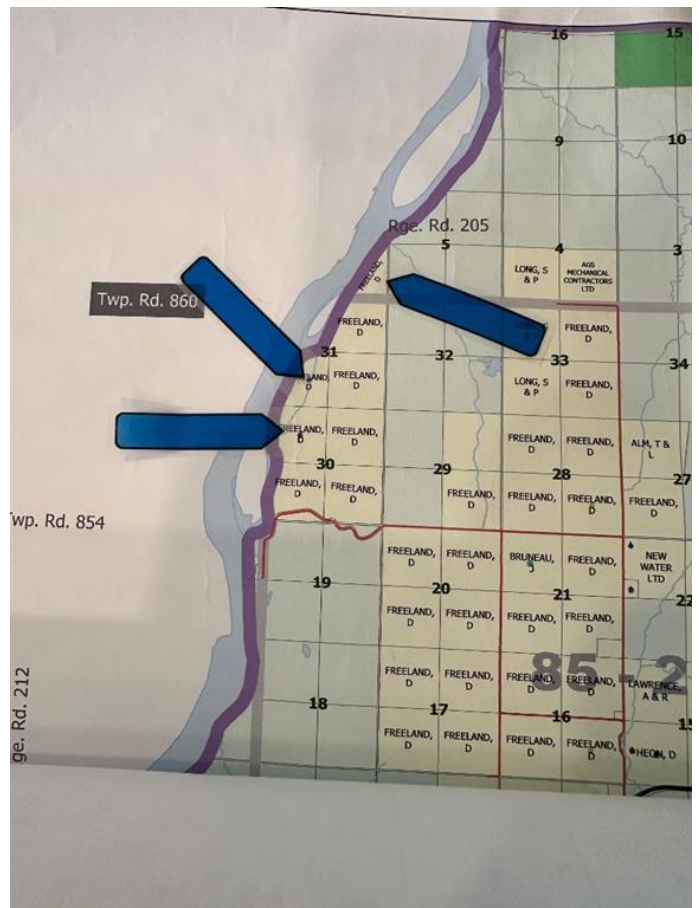

looking for that special place to Call Home to make memories that last a life time, This is the place and the time is Now. Many memories were made over the years now it is time for you to make your own Priceless Memories. Schedule your Private Tour Today and discover the endless possibilities of this 309-acre Sanctuary!!!

Built in 2000

Essential Information

MLS® #	A2243827
Price	\$1,495,000
Bedrooms	3
Bathrooms	2.00
Full Baths	1
Half Baths	1
Square Footage	1,506
Acres	0.00
Year Built	2000
Type	Agri-Business
Sub-Type	Agriculture
Style	Bungalow
Status	Active

Community Information

Address	Range Road 210
Subdivision	NONE
City	Rural Northern Sunrise County
County	Northern Sunrise County
Province	Alberta
Postal Code	T0H 3B0

Amenities

Parking Spaces	20
Parking	Driveway

Interior

Interior Features	Built-in Features, Ceiling Fan, Floorplan, Pantry, See Remarks
Appliances	Dishwasher, Gas Stove, Washer/Dryer
Heating	Forced Air, Propane
Cooling	Central Air
Basement	None



Exterior

Exterior Features	Fire Pit, Other
Roof	Metal
Construction	Cedar, Wood Frame
Foundation	Piling(s)

Additional Information

Date Listed	July 28th, 2025
Days on Market	1
Zoning	agri

Listing Details

Listing Office	Royal LePage Valley Realty
----------------	----------------------------

Data is supplied by Pillar 9â„¢ MLSÂ® System. Pillar 9â„¢ is the owner of the copyright in its MLSÂ® System. Data is deemed reliable but is not guaranteed accurate by Pillar 9â„¢. The trademarks MLSÂ®, Multiple Listing ServiceÂ® and the associated logos are owned by The Canadian Real Estate Association (CREA) and identify the quality of services provided by real estate professionals who are members of CREA. Used under license.